

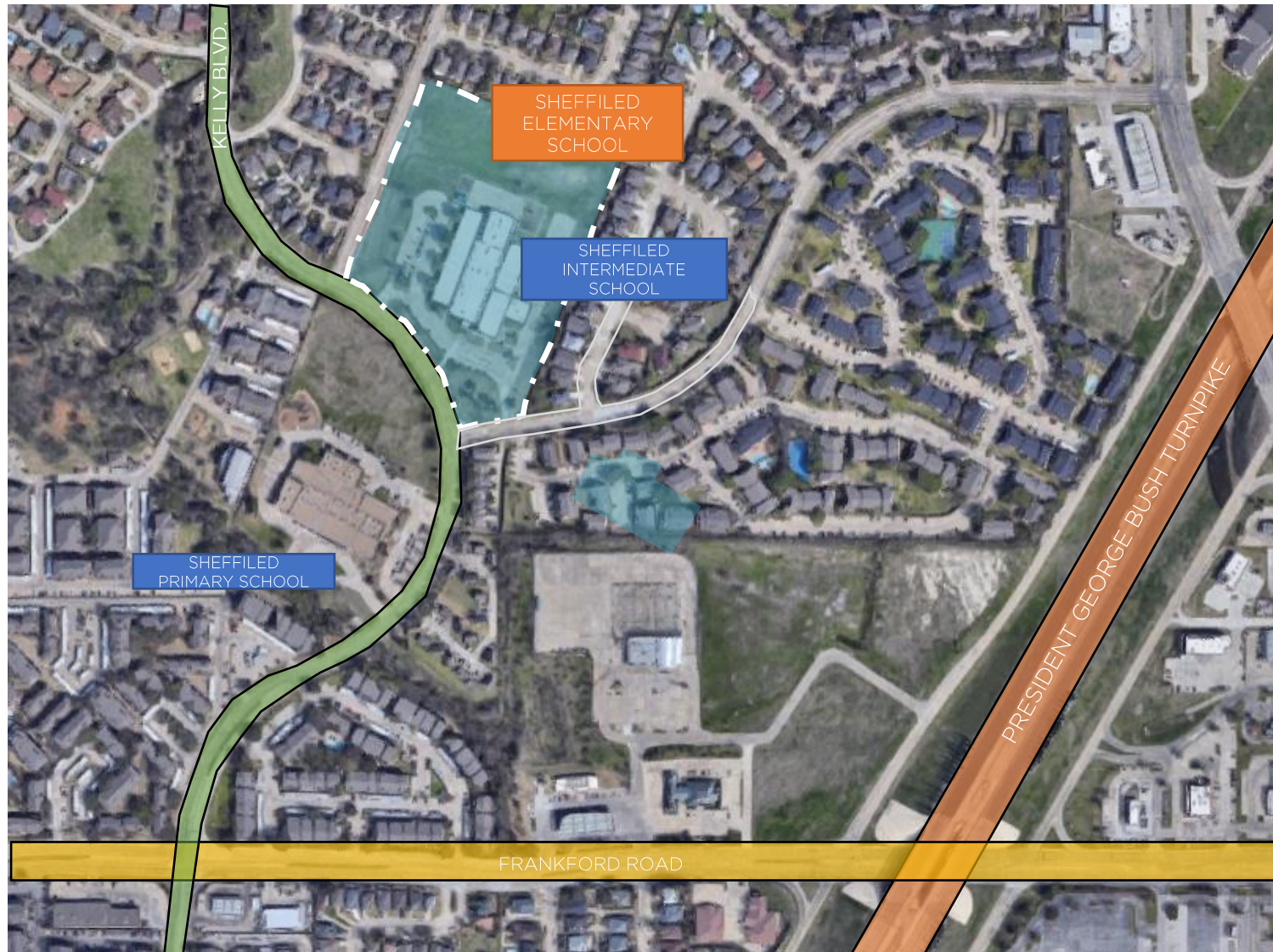

Sheffield Elementary School

Location



**NEAR THE INTERSECTION OF
PRESIDENT GEORGE BUSH TURNPIKE
AND FRANKFORD ROAD IN
CARROLLTON, TEXAS.**

Sheffield Elementary School

Site Plan



Sheffield Elementary School

Traffic Flow



- PARENT ENTRANCE ON TIMBERGLEN ROAD
- BUS ENTRANCE ON TIMBER OAKS DRIVE
- NO TRAFFIC ON KELLY BULLIVARD
- ALL TRAFFIC WILL EXIT ONTO TIMBER OAKS DRIVE





- PARENT DROP OFF / PICK UP
- BUS DROP OFF / PICK UP

Sheffield Elementary School

Staging Plan - Construction

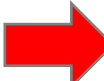

- PRIMARY CONSTRUCTION ENTRANCE TO BE LOCATED AT EXISTING SCHOOL EXIT.

-  LAYDOWN / FLEXBASE WITH FABRIC
-  JOBSITE FENCING FOR SECURITY / SAFETY
-  JOBSITE TRAILOR
-  ROCK CONSTRUCTION ENTRANCE
-  PRIMARY CONSTRUCTION ENTRANCE

Overall Project Schedule

Design/CDs: September 2019-May 2020

Bidding/Permitting: May 2020-October 2020

Construction: October 2020-May 2022

- Schematic Design
- Design Development
- Construction Documents
- Permitting
- Construction
- Occupancy

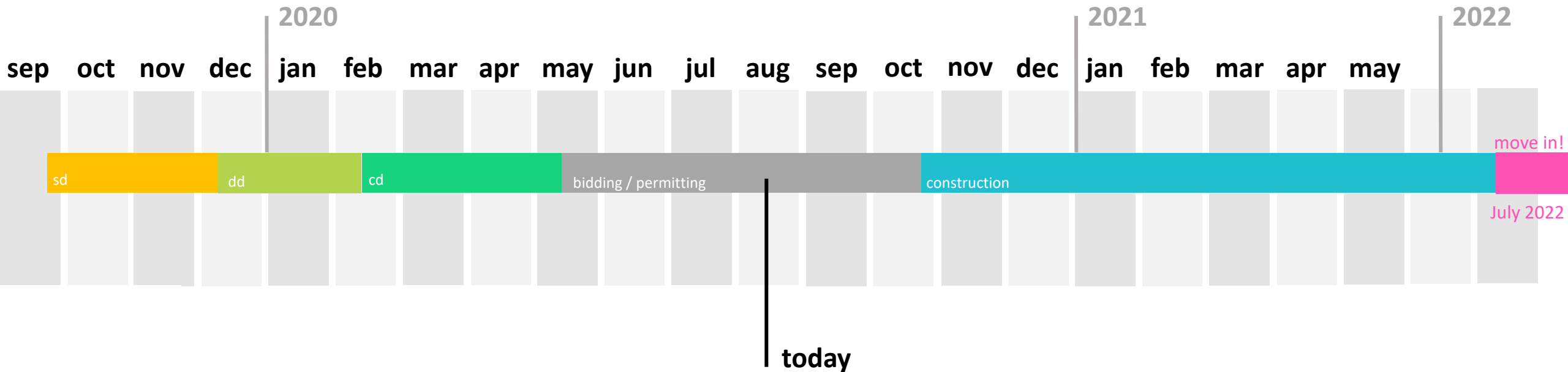

Exterior – Front Entrance

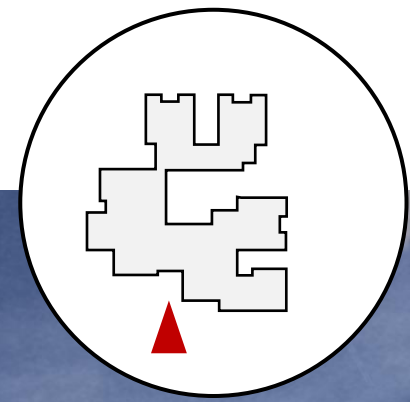

Exterior- Courtyard

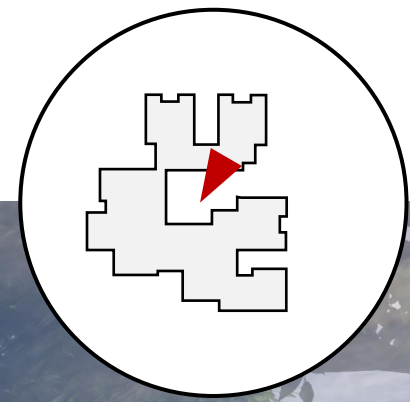

Exterior – Bus Drop Off

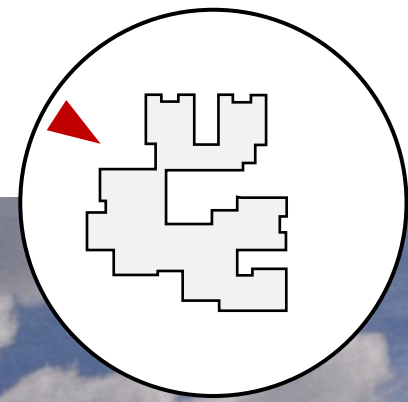

Floor Plan

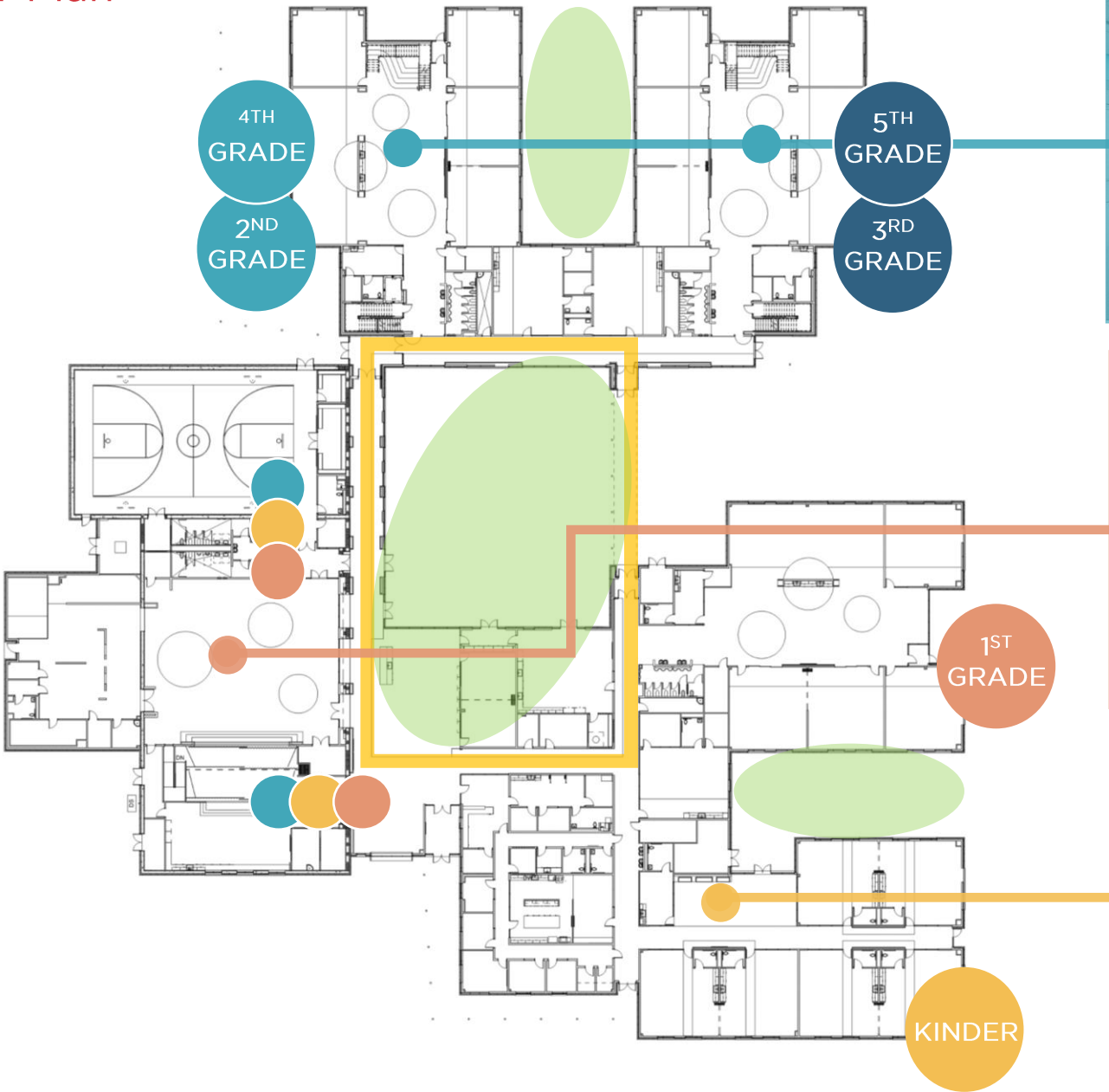



QUESTIONS?

PLEASE SUBMIT YOUR QUESTIONS AND COMMENTS TO:

972-968-6100
cfbinfo@cfbisd.edu

CFBBOND.COM